



Fill & Seal Station

By Coffee Crafters

Assembly Instructions



Coffee Crafters

Post Falls, Idaho, USA

www.CoffeeCrafters.com



TABLE OF CONTENTS

Warranty and Guarantee.....Page 3-5

Assembling Your Fill & Seal Station.....Page 6-15



WARRANTY AND GUARANTEE

Fill & Seal Station Warranty

Your Fill & Seal Station has been manufactured and tested to the highest quality standards by Coffee Crafters. This Limited Warranty covers defects in material or workmanship on new Fill & Seal Stations. The Warranty extends to the original purchaser only and is non-transferable. Only customers purchasing Fill & Seal Stations from Coffee Crafters may obtain coverage under our limited warranty.

Coffee Crafters warrants this product against defects in material or workmanship as follows:

- Under normal installation per Coffee Crafters instructions, use, service, and maintenance for a period of one year from the original purchase date, Coffee Crafters will replace, at no charge, any product or part of the product that proves defective because of improper workmanship and/or material.

The specific warranties expressed are the ONLY warranties provided by the manufacturer. These warranties give you specific legal rights, and you may also have other rights which vary from state to state.

What is not covered by the Warranty

1. Conditions and damages resulting from any of the following:
 - a. Improper installation, delivery, or maintenance.
 - b. Any repair, modification, alteration, or adjustment not authorized by the manufacturer.
 - c. Misuse, abuse, accidents, unreasonable use, or acts of God.
 - d. Improper setting of any control.
 - e. Use of risers (pedestals) that are not authorized by the manufacturer.



- f. The Warranty is void if a product is returned with removed, damaged, or tampered labels or equipment, or any alterations.
- 2. Products purchased for use other than roasted coffee or any other approved dry particulate as stated as okay by Coffee Crafters.
- 3. Any food loss due to product failures.
- 4. Expenses for travel and transportation for product service.
- 5. Consequential or incidental damages sustained by any person as a result of any breach of these warranties.
 - a. Some states do not allow the exclusion or limitation of consequential or incidental damages, so the above exclusion may not apply.
- 6. Equipment other than Fill & Seal Station purchased through Coffee Crafters.

If You Need Service

Give us a call or send us an email and we will be happy to help.

- a. Phone: 509-228-6916
- b. Email: info@coffeecrafters.com

30-Day Complete Satisfaction & Money-Back Guarantee

We want you to be fully satisfied with every item that you purchase from Coffee Crafters. If you are not satisfied with an item that you have purchased, you may return the item within 30 days of delivery for a full refund of the purchase price, minus the shipping, handling, or other additional charges. The item must be returned in new condition, in original boxes, and with all paperwork, parts and accessories to ensure full credit.



Return Instructions

1. Contact Coffee Crafters Customer Service Department at 1-509-228-6916 to begin the return process.
2. Pack the item securely in the original package, if possible. Enclose the return portion of the original packing slip with the item.
3. All products must be returned in excellent condition, in original boxes, and with all paperwork, parts and accessories to ensure full credit.
4. All return shipping charges must be prepaid. We cannot accept C.O.D. (cash on delivery).
5. Keep the Return Tracking Number from the package you are returning to ensure that the package is returned to the warehouse.
6. You can expect a refund in the same form of payment originally used for purchase usually within 10-15 business days of our receiving your returned product. Returned funds may reflect charges for incomplete components or damaged materials. Delays may be experienced in the case of incomplete returns. Please note that your shipping costs will not be refunded.

Receipt of Damaged or Defective Items

If you receive a damaged or defective item, contact Coffee Crafters Customer Service Department at 509-228-6916. Please supply the Representative with your order number, item number and tracking number from your original confirmation e-mail. The Representative will also need your e-mail address and phone number. We will make every reasonable effort to assist you with your return. If you do not contact Customer Service, you are responsible for all return shipping charges.

A defective item may be repaired or replaced within 90 days of purchase under Coffee Crafters Warranty.



ASSEMBLING YOUR F&S STATION

The hardware for assembling your new Fill & Seal Station is individually labeled for the parts that they go to. The following steps will easily outline how to assemble your unit and get you up and running in no time! If you run into any issues or have any questions during the assembly process, please reach out to us and we will be happy to guide you through it.

Step 1: Remove shrink wrap and carriage assembly from the work top.

Step 2: Turn the work top over so it is upside down. Install the cup chute using the provided 6/32 screws (6) and 6/32 keps nuts (6) as shown below. Make sure the chute is installed with the angle facing toward the front of the F&S Station as shown in picture 2.

DO NOT OVERTIGHTEN!!! This piece is made of plastic and will crack.

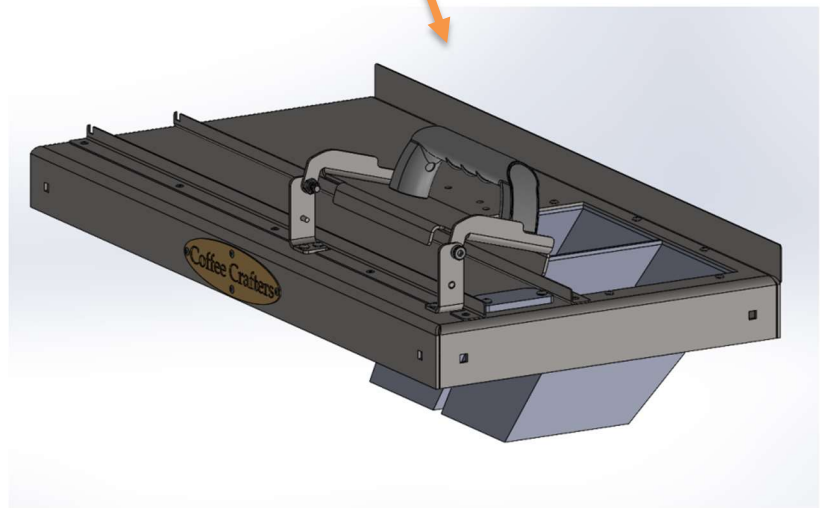
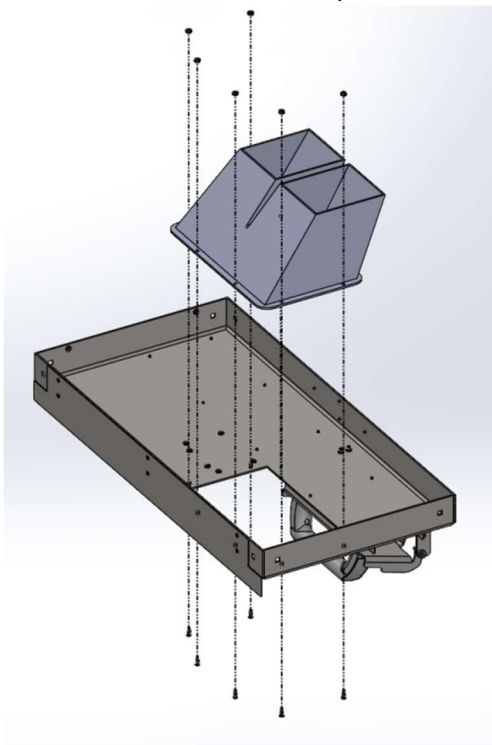



Step 3: Install one foot onto each of the four legs using one ¼-20 lock washer and one ¼-20 nut per foot.

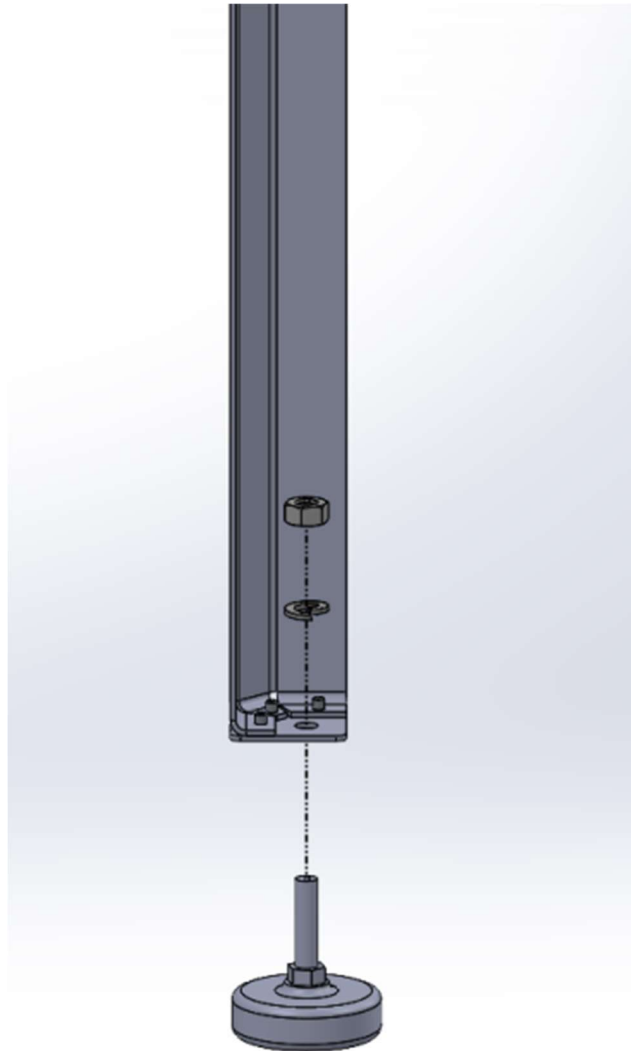



Step 4: Install the two legs on the right side of the work top using two square neck carriage bolts, two ¼-20 lock washers and two ¼-20 nuts per leg. Do the same for the two left legs, making sure to have the plate facing out as shown below.

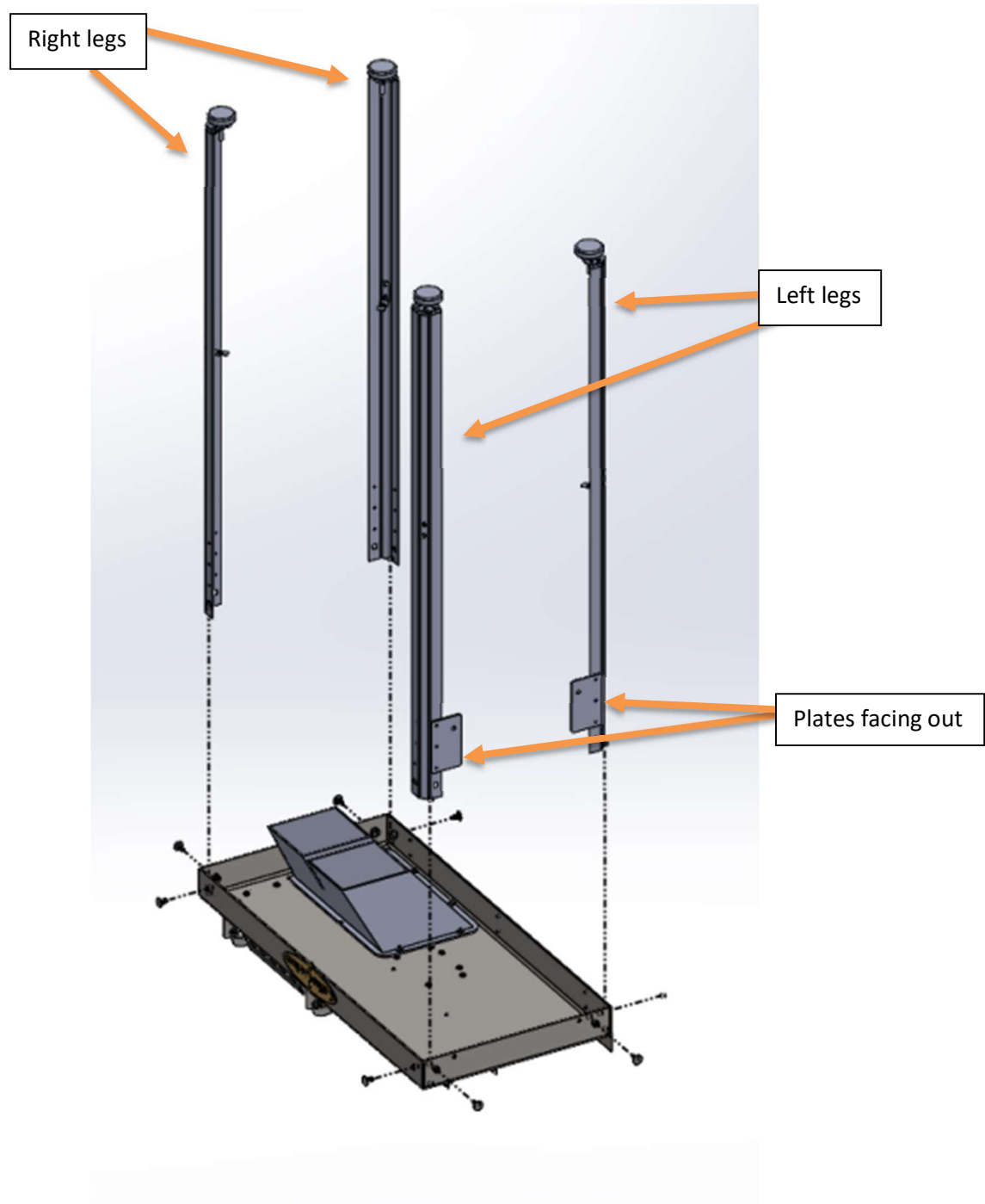



Step 5: Flip the F&S Station back over so it is upright.

Step 6: Install the bottom shelf onto the brackets using the 4, 8/32 half inch screws. Make sure to have the holes on the shelf on the right side. This is where you will install the box insert later.

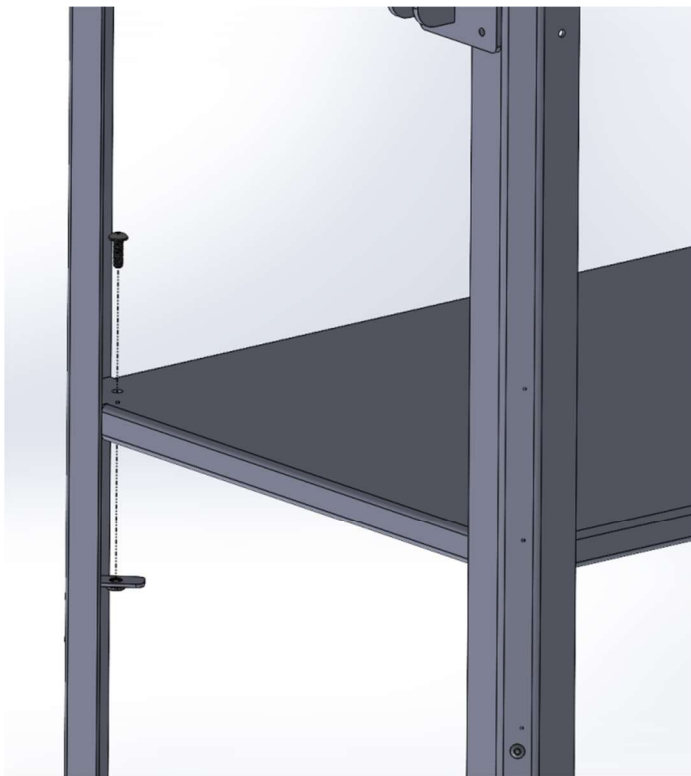

Close Up View





Step 7: Install the folding tray onto the leg plates on the left side of the unit using the 4, 8/32 half inch screws. There are also 2, #10 flat washers that will be used on the bottom two holes. The top holes will not need washers.

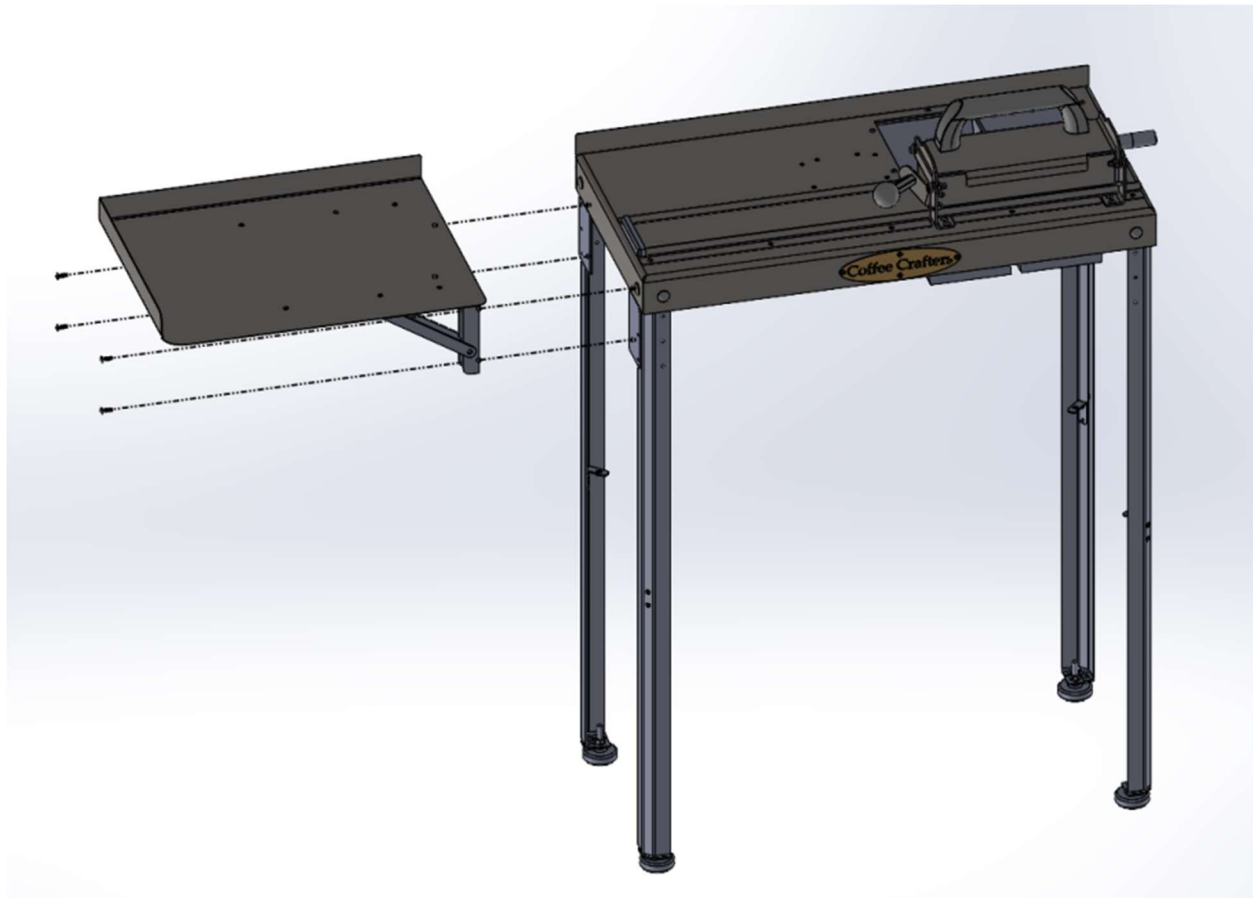



Step 8: Install handle onto carriage assembly.

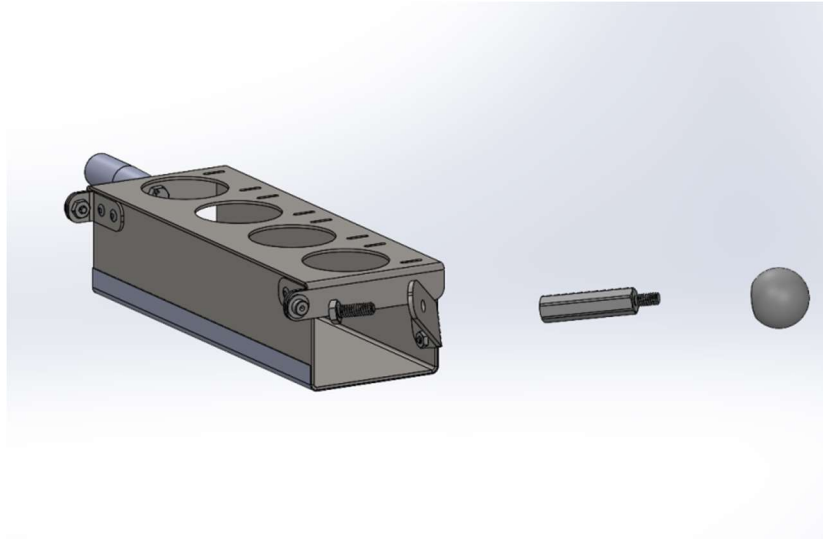

Step 9: Install carriage stop bar onto the work top as shown below. This piece snaps into place with the flat side facing the right.

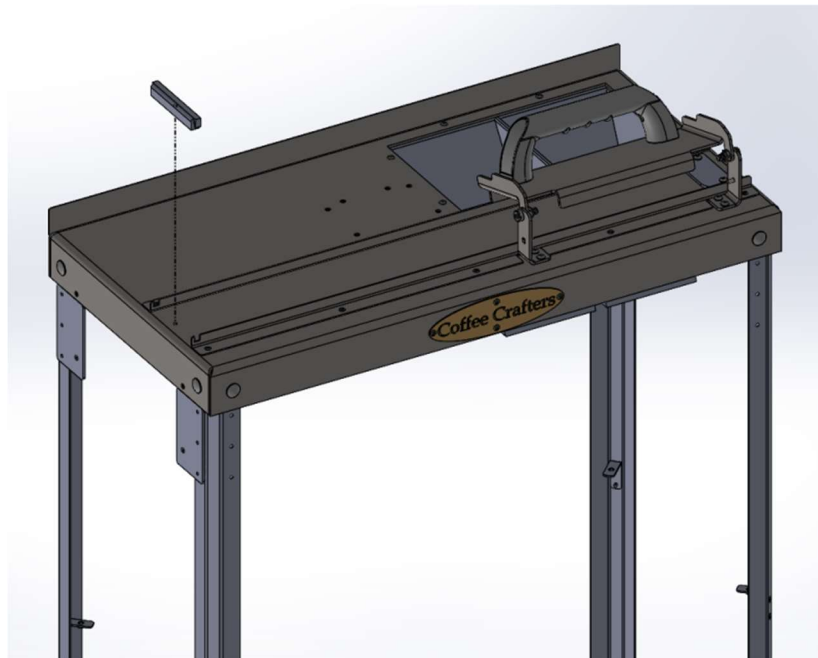



Step 10: Place the carriage back onto the slide as shown below.

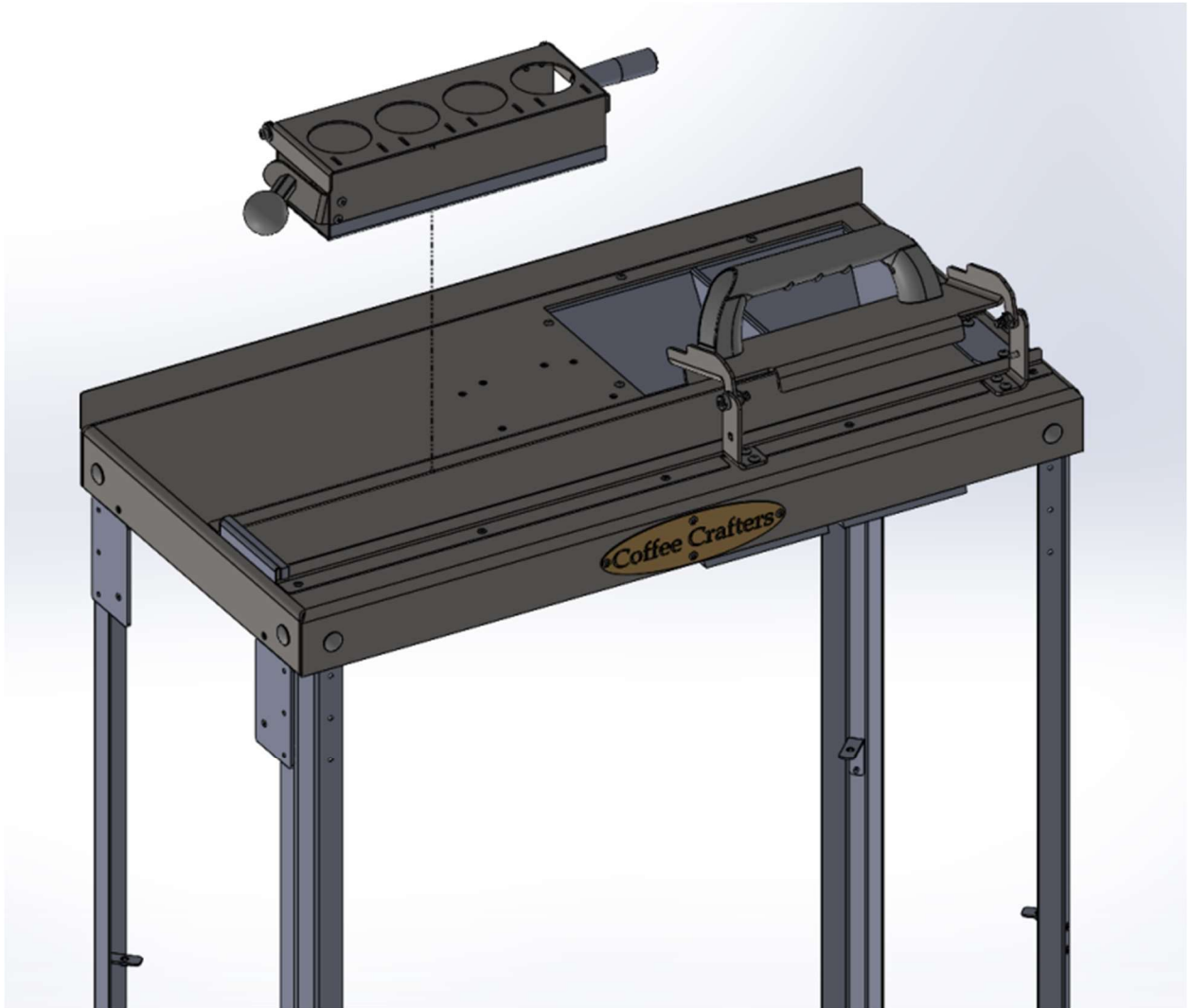



Step 11: Install the fill station onto the work top using the 6, 8/32 half inch screws. Make sure the handle for the dosing mechanism is facing toward the front of the unit.

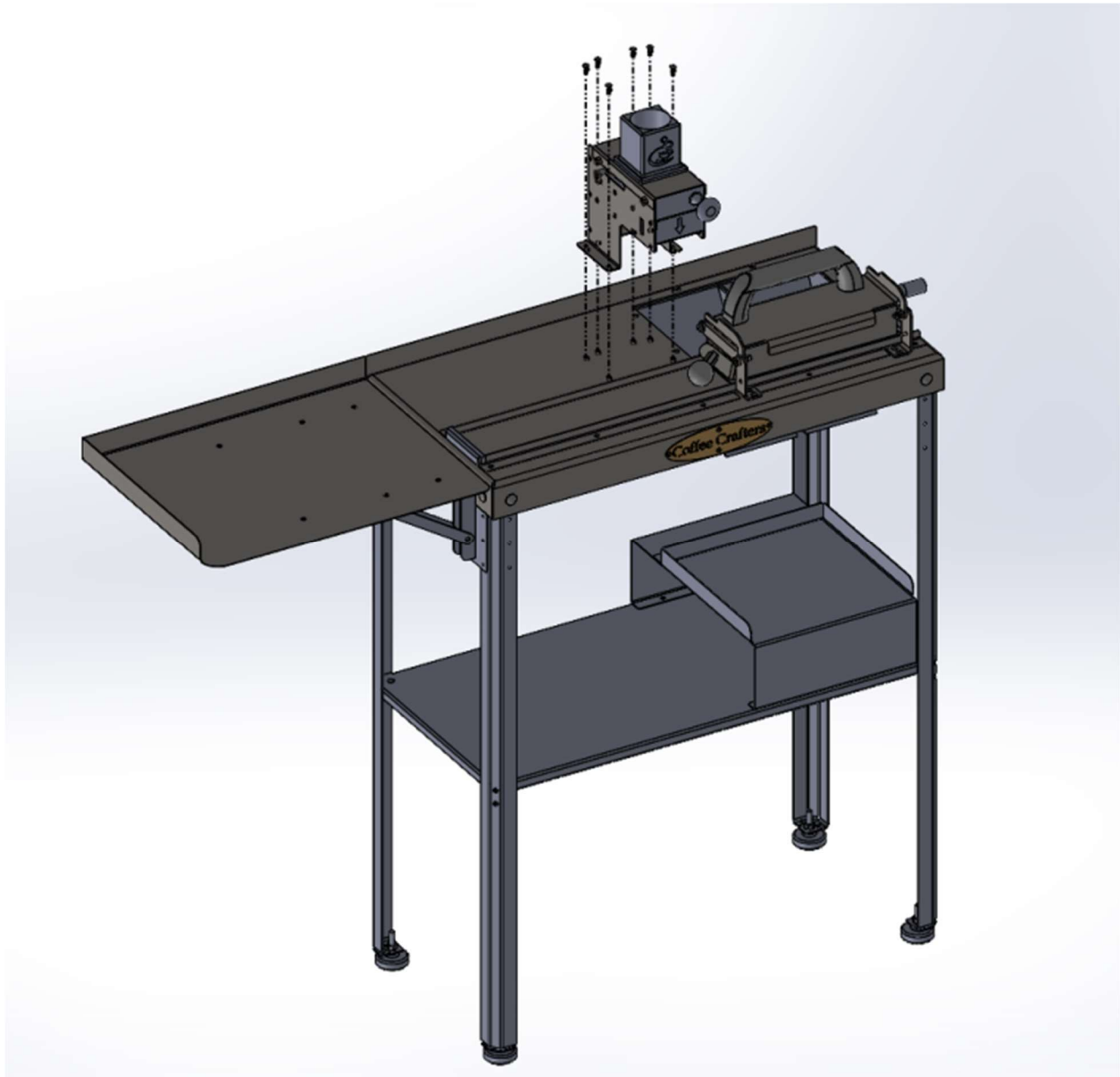



Step 12: Place funnel on top of the fill station as shown below.

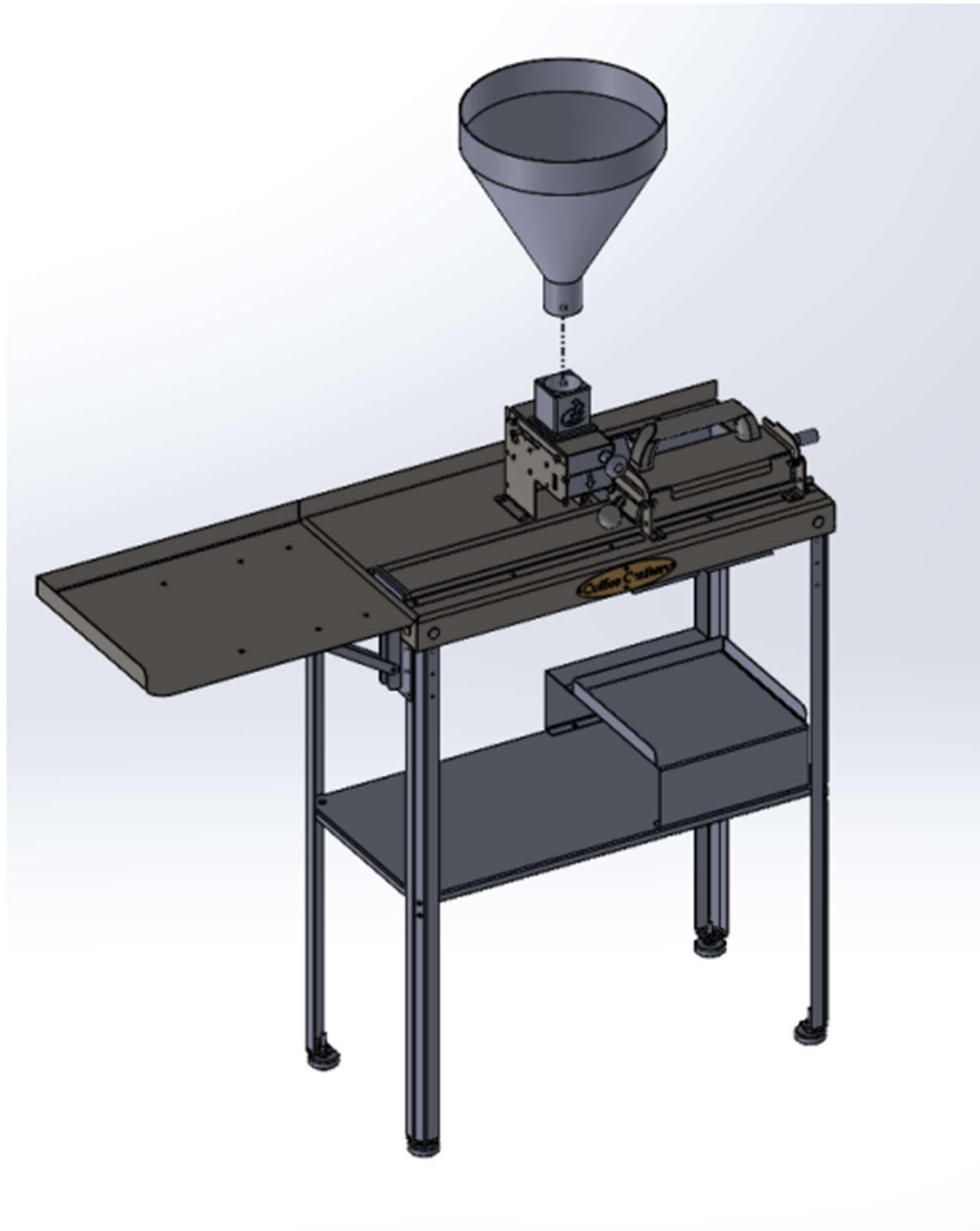



Step 13 (optional): If you plan on dumping the cups directly into an iFill Box underneath the chute, you will need to install the box insert. This piece does not require hardware and all you need to do is place the pins on the insert into the holes on the bottom shelf as shown below.

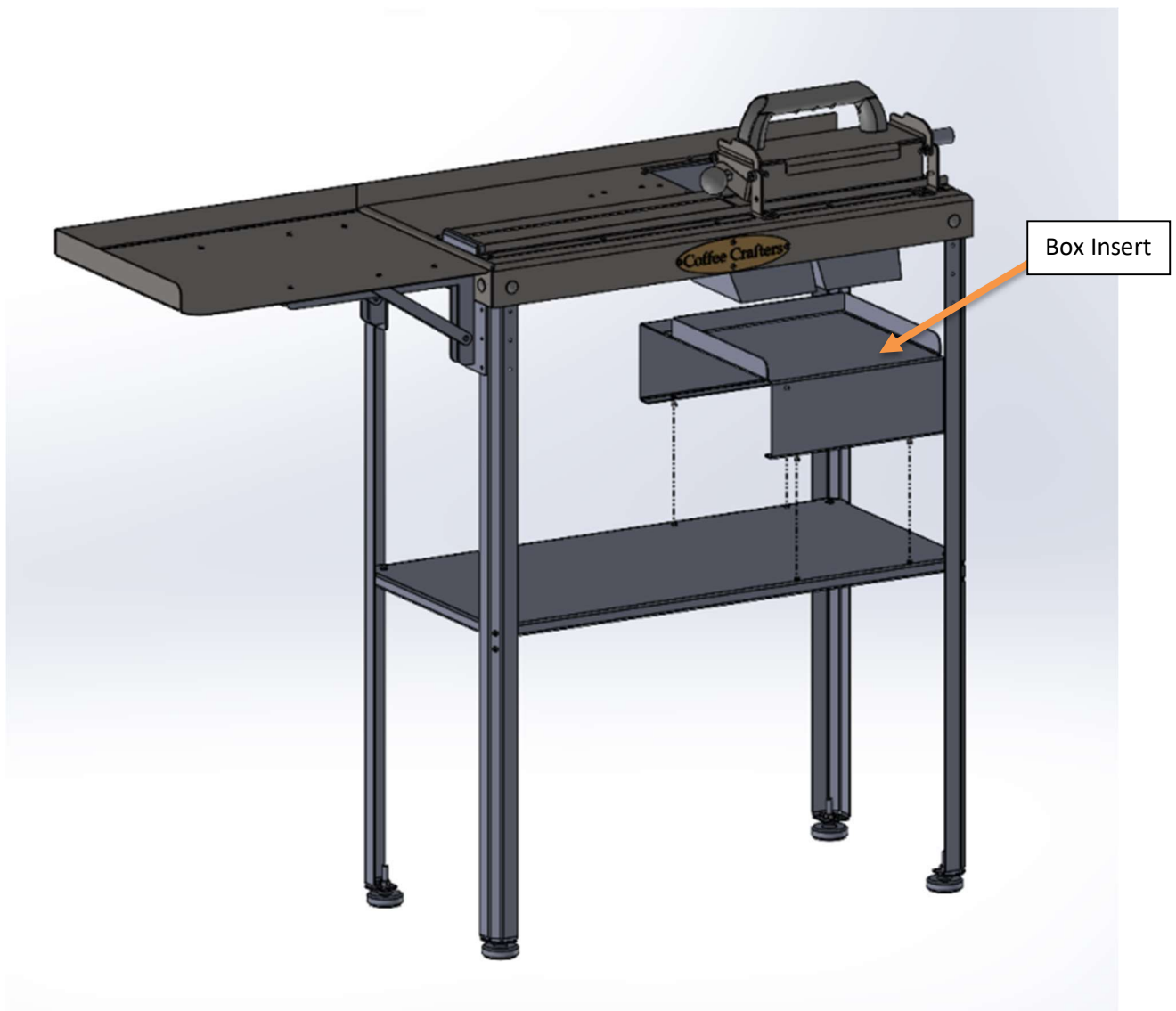

You are now ready to use your new Fill & Seal Station!!!